



JK FRONT BUMPER

www.TERAFLEX.com

Part #4653100

Part #4653200

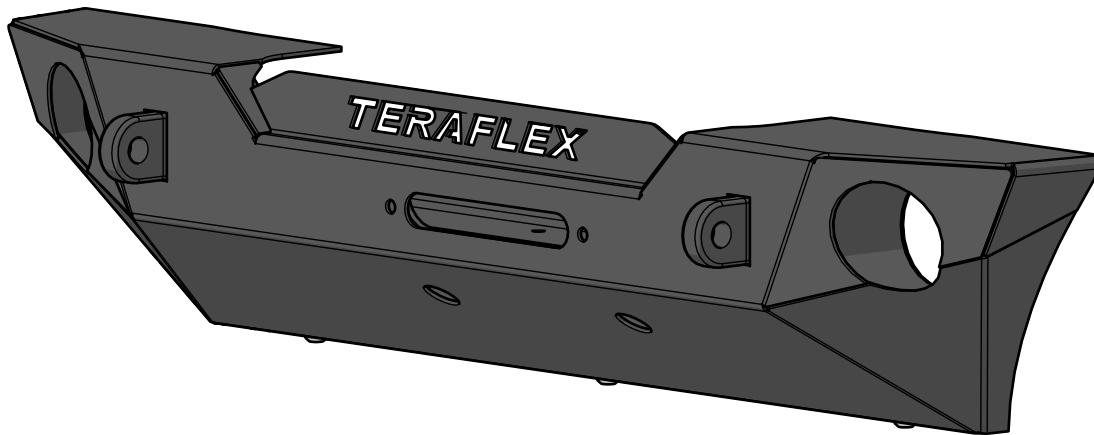

Important Notes:

Prior to beginning this or any installation read these instructions to familiarize yourself with the required steps and evaluate if you are experienced and capable to personally perform these modifications. A factory service manual should be used in conjunction with these installation instructions.

Refer to the parts list to ensure that all necessary components and hardware has been included. If any parts are missing please contact your local TeraFlex dealer for assistance.

For 2012 and newer Jeeps, it may be necessary to purchase and install the vacuum pump relocation kit (#4403100). The bumper may not fit properly without the vacuum pump being relocated.

Install bumper first then install your winch.

Tools needed:

- Drill and 1/2" or 9/16" Drill Bit
- General mechanics tool set
- 18mm and 5/16" Sockets
- 3/4" wrench
- Ratchet and Extension
- Philips and Common Screw Driver

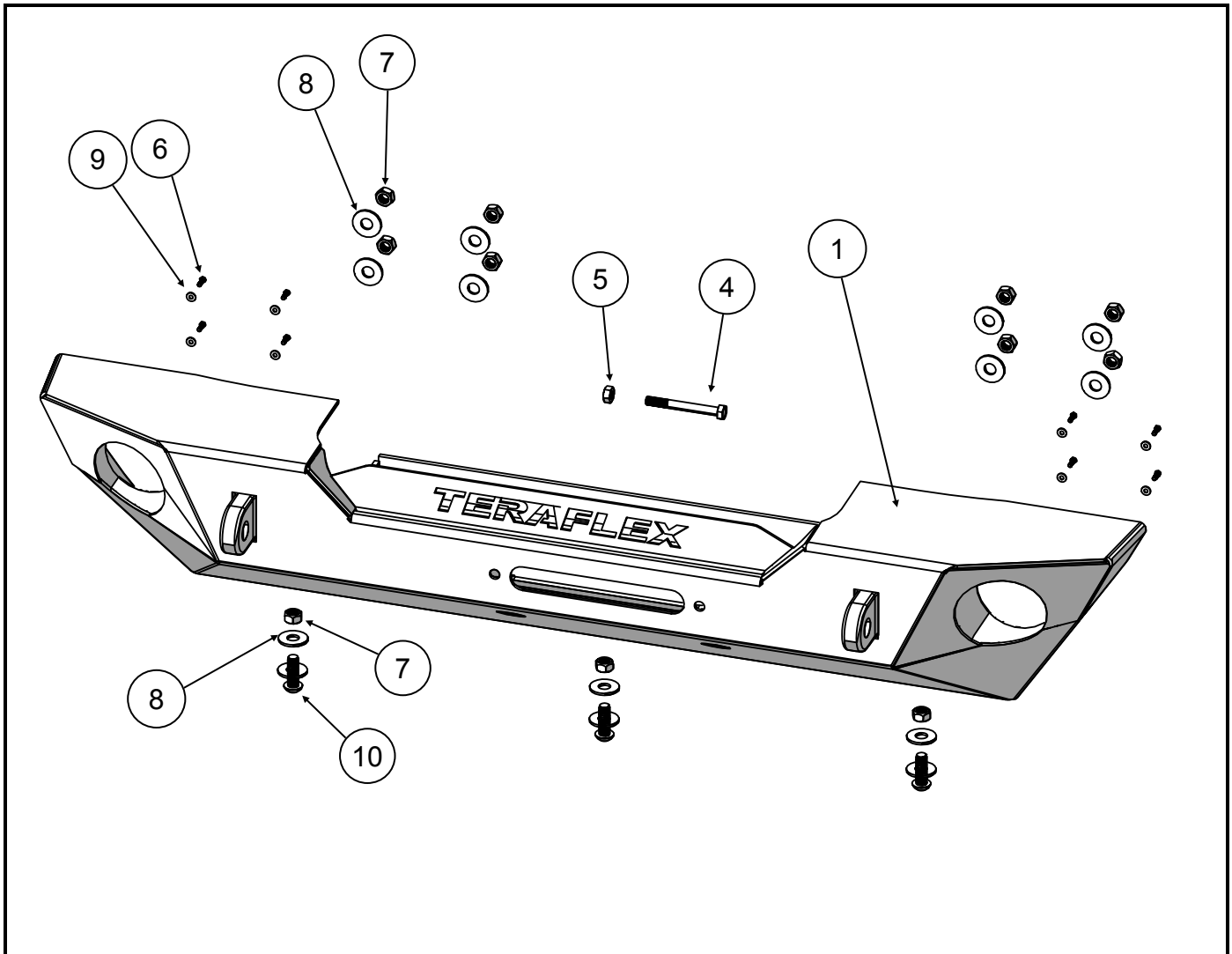

Item #	Part #	Description	QTY
1	1653100	JK Front Epic Bumper w/ Fog Light Mount	1
2	4603100	Hardware Kit for JK Front Epic Bumper	1
3	5045	Nut Bolt JK Front Bumper Hardware Bag 888	1
4	158	Nut M10 x 1.5 x 90mm Hex Head Zinc Plated	1
5	1621	Nut M10 x 1.5 Zinc Plated	1
6	17	Bolt #8-32 x 1/2" Zinc Plated Hex Head with Slot	8
7	488	Nut 1/2"-20 Nylock Nut Hex Head Zinc Plated	11
8	37	Washer 1/2" Flat Washer Zink Plated	14
9	55	Washer #8 Flat Zinc Plated	8
10	567	Bolt 1/2"-20 x 1.5" Button Head Socket	3

Using a phillips screw driver, remove the 2 push pin fasteners (1) on the front cross member decorative cover (2), and slide the cover to gain access the nuts that attach the bumper to the frame. The push pin fasteners can be released by using a phillips screw driver to unscrew the center screw until the push pin can be removed.



1

Remove the front splash shield (1) by removing the 4 push pin fasteners(2) connecting it to the bumper the 2 push pin fasteners (3) that connect it to the frame behind the splash shield.

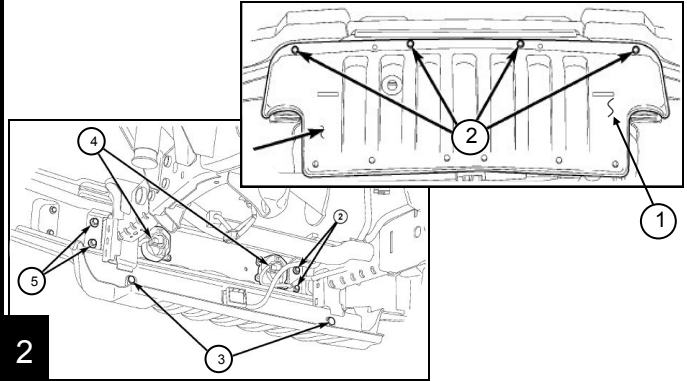

2

Disconnect the fog light connectors (4) by gently prying up the retaining clip with a flat blade screw driver and pull off the connector.

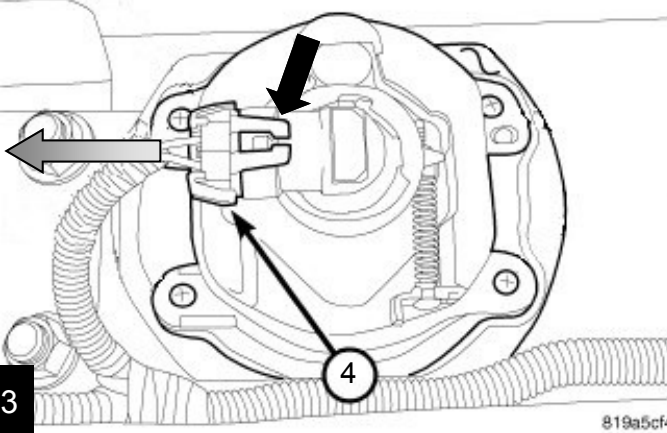

3

Using a panel clip remover tool or flat head screw driver remove the 4 push pin clips that hold the fog light wiring harness to the back side of the front bumper.



4

Using an 18mm socket, ratchet and an extension, remove the 8 nuts(5) and 4 washer plates(a) that attach the studs from the bumper to the frame, 4 on each side. Slide the front cross member decorative cover to gain access to the nuts.

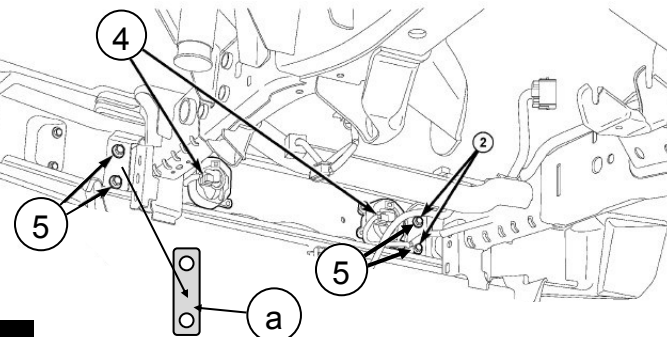

5

With the nuts and washer plates removed, now the cross members decorative cover and the front bumper can be removed.

Note: Washer plates will not be reused.

Note: The factory fog light wiring will need to be extended by the installer. In some cases, there may be enough wire in the harness to stretch to the new lamp location versus splicing the harness.



6

Take the fog lamps out of the stock bumper and install them into the new Teraflex bumper with the eight #8 bolts(4) and washers(10) (four screws and washers per lamp).

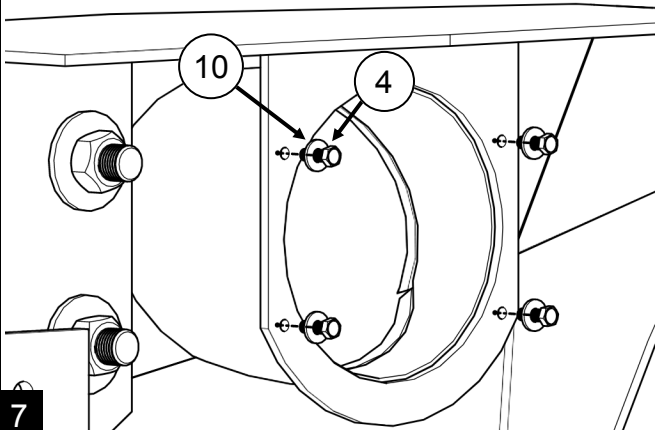

If the Jeep is equipped with an electronic sway bar, it is necessary to push the rubber mount over closer to the frame so it will clear the bumper. To do this, **1st** remove the current mounting bolt and push the rubber mount toward the frame rail. **2nd**, install the provided M10 X 90mm bolt through the rubber mount. **3rd**, thread the provided M10 jam nut on to the bolt most of the way. **4th**, install the M10 bolt into the electronic sway bar housing (about 1/2"-3/4" in) and use the jam nut to torque down the bolt.

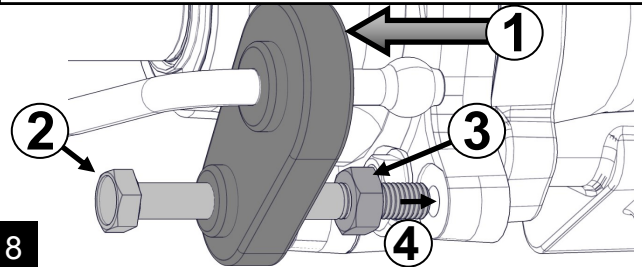

Some Wranglers will require trimming of the side brackets on the front cross member (picture 1). Using a grinder with a cut-off wheel, cut the excess off so that both side brackets are flush with the cross member (picture 2). After trimming spray paint exposed metal black to prevent rust.

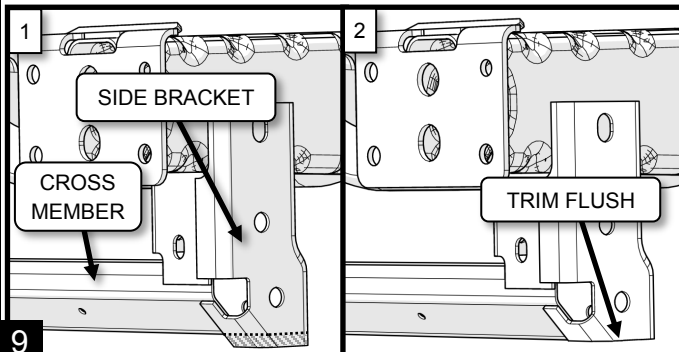

Install the new Teraflex Bumper with **EIGHT** 1/2" lock nuts(7) and washers(8)

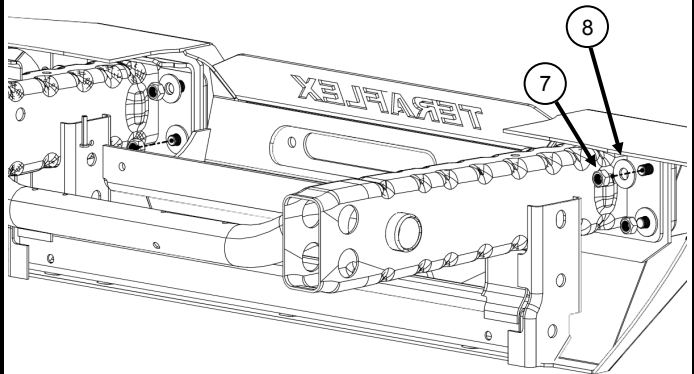

Install a button head cap screw(10), with washers(8) and a nut(7), into the bottom of the bumper, where a hole lines up. For the other two (depending on model year) the holes will need to be drilled using a 1/2" or 9/16" drill bit. Install the hardware into the second and third bolt after drilling the required holes.

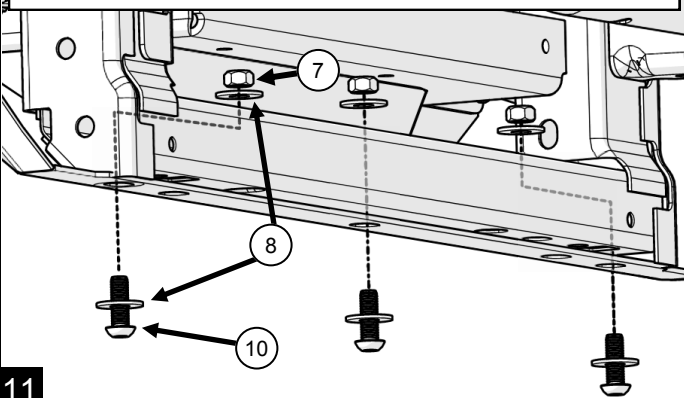

Make sure the bumper is centered on its mounts and torque the mounting bolts to 75-80 ft-lbs.

Re-torque bolts after 1000 - 3000 miles of driving.

Always check these and other equipment after going offroad.

TERAFLEX

PRODUCT INFORMATION

MAINTENANCE INFORMATION:

It is the buyer's responsibility to have all suspension, drivetrain, steering, and other components checked for proper tightness and torque after the first 100 miles and every 3000 miles after that.

NOTICE TO INSTALLER:

The enclosed "Warning to Driver" sticker must be installed in the vehicle in driver's view. This sticker is to act as a constant safety reminder when operating the vehicle. It is your responsibility as the equipment installer to install the provided sticker and to forward the product instructions to the vehicle's owner for review. If a "Warning to Driver" sticker or product installation guide were not included in the kit, FREE replacement stickers and instructions are available by request. It is the installer's duty to ensure a safe and controllable vehicle after the modifications have been performed.

WARNING:

Neither the seller nor the manufacturer will be liable for any loss, damage, or injury directly or indirectly arising from the use of or inability to determine the use of these products. Before using, the user shall determine the suitability of the products for its intended use, and the user shall assume all responsibility and risk in connection therewith.

WARNING TO DRIVER:

This vehicle has been modified to enhance off road performance and has unique handling characteristics. Use in harsh environments can cause extreme stress on the components. Vehicle should be inspected after being off road to make sure that all the components are in working order and safe to travel on the highway. All fasteners should be checked so that they are at the correct torque specifications as the vibration and stresses from off roading may cause critical fasteners to work loose. Extra care should be taken to inspect the critical components, steering, and brake systems. During each oil change components such as arms, tie rod ends, etc should be greased and checked for excessive wear. Any worn components should be replaced. When returning to the pavement always set or restore tire air pressure to the factory recommendation and connect or engage any disabled sway bar mechanisms. Because of the higher center of gravity and larger tires, this vehicle handles and reacts differently than many passenger cars, both on and off road. You must drive it safely! Extreme care should be taken to prevent vehicle rollover or loss of control, which can result in serious injury or death. Avoid sudden sharp turns or abrupt maneuvers. Generally, braking performance and capabilities are decreased when significantly larger/heavier tires are used, especially when used in combination with transfer case low-range reduction kits. Take this into consideration while driving. Do not add, alter or fabricate any factory or aftermarket parts to increase vehicle height over the intended height of the TeraFlex product purchased. Mixing component brand is not recommended. TeraFlex Inc. will not be responsible for any altered product or any improper installation or use of our products. We will be happy to answer any questions concerning the design, function, and correct use of our products. It is ultimately the buyer's responsibility to have all bolts/nuts checked for tightness after the first 100 miles and then every 3000 miles. Wheel alignment, steering system, suspension and drive line systems must be inspected by a qualified professional mechanic at least every 3000 miles.

TERAFLEX PRODUCT WARRANTY:

TeraFlex Inc. warrants TeraFlex Suspension products to the original retail purchaser to be free of defects in material and workmanship for as long as the original purchaser owns the vehicle on which products were originally installed.

Failure to complete regular maintenance (grease every 3000 miles) on TeraFlex FlexArms will void this warranty. All other conditions of the standard TeraFlex product warranty apply.

All TeraLow products are covered by the TeraFlex two (2) year warranty to be free of defects in material and workmanship for two years from date purchased.

TeraFlex axles are covered by a 12-month warranty to be free of defects in materials and workmanship.

This warranty does not cover or include product finish, improperly installed or applied products, improperly maintained products, products or components used for racing or competition or damage due to abuse or neglect, products that fail due to the use of larger tire and wheel combinations.

All returns must be accompanied by an original invoice. It is the customer's responsibility to remove the product from the vehicle. Shipping charges are the responsibility of the customer. TeraFlex Inc. will pay the return freight if the product meets the terms of warranty.

This warranty is for the replacement or repair of defective TeraFlex products only and does not include freight charges, labor charges for removal of or installation of TeraFlex or related products or components, costs incurred due to down time of the vehicle, or lost profits due to vehicle down time.

A returned goods authorization number (RGA#) must accompany any returned products. For more information please contact a TeraFlex customer service representative.

COPYRIGHT

©Copyright 2014. All rights reserved, TeraFlex Inc. Reproduction of this catalog and/or any of its contents without written permission is strictly prohibited.

TeraFlex® is a registered trademark of TeraFlex Inc. All trade names and logos including but not limited to TeraFlex, FlexArms, RockGuard, Monster, and LCG are protected by law and duplication of trade names and/or logos are strictly prohibited.

TeraFlex Inc. reserves the right to update, discontinue, redesign, modify finish, part number or component build parts if deemed necessary without written notice.

TeraFlex Inc., and any associated dealers are not responsible for misprints or typographical errors that may have inadvertently been made within this instruction sheet.

TERAFLEX, Inc.

5680 West Dannon Way
West Jordan, Utah 84081
Phone/801.713.3314
Fax/801.713.2313
www.teraflex.com

Jeep® and the Jeep® grill are registered trademarks of Fiat Chrysler Automobiles N.V., and have no affiliation with TeraFlex Inc.